

C:\Users\jg\OneDrive\Documents\FFA Arena\Drawings\FFA_Arena_Civil_18_19_19.dwg

GENERAL FLOOR PLAN NOTES

FLOOR PLAN NOTES:

1. Refer to all references in the Contract Documents, drawings & specifications.
2. The contractor shall be responsible for obtaining all necessary permits, fees, and approvals for construction, including but not limited to, zoning, fire, and building department approvals.
3. All work shall be in accordance with the approved plans and specifications, and shall be subject to the approval of the Architect.
4. The contractor shall be responsible for obtaining all necessary permits, fees, and approvals for construction, including but not limited to, zoning, fire, and building department approvals.
5. All work shall be in accordance with the approved plans and specifications, and shall be subject to the approval of the Architect.
6. All work shall be in accordance with the approved plans and specifications, and shall be subject to the approval of the Architect.
7. All work shall be in accordance with the approved plans and specifications, and shall be subject to the approval of the Architect.
8. All work shall be in accordance with the approved plans and specifications, and shall be subject to the approval of the Architect.

FLOOR PLAN LEGEND

	DOOR TAG
	COLUMN GRID
	ROOM LABEL
	ROOM TAG
	SECTION ELEVATION CALLOUT
	ELEVATION TAG
	WINDOW TAG
	CENTER LINE

WALL LEGEND

	EXTERIOR WALL
	CONCRETE
	CONCRETE MASONRY
	METAL STUD WALL
	OPEN WALL
	1 HOUR RATED
	2 HOUR RATED
	3 HOUR RATED

WALL TYPES LEGEND

	Furring
	Wall Studs
	Wall Studs with Furring
	Insulation
	Drywall
	Acoustic Drywall
	Soundproofing

ACCESSORY LEGEND

	1/2\"/>
	3/4\"/>
	1\"/>
	1 1/2\"/>
	2\"/>
	2 1/2\"/>
	3\"/>
	4\"/>
	6\"/>
	8\"/>
	12\"/>

KEY NOTE LEGEND

	CORNER GUARD
	FOLDING PANEL PARTITION
	LINE OF JOINT PART

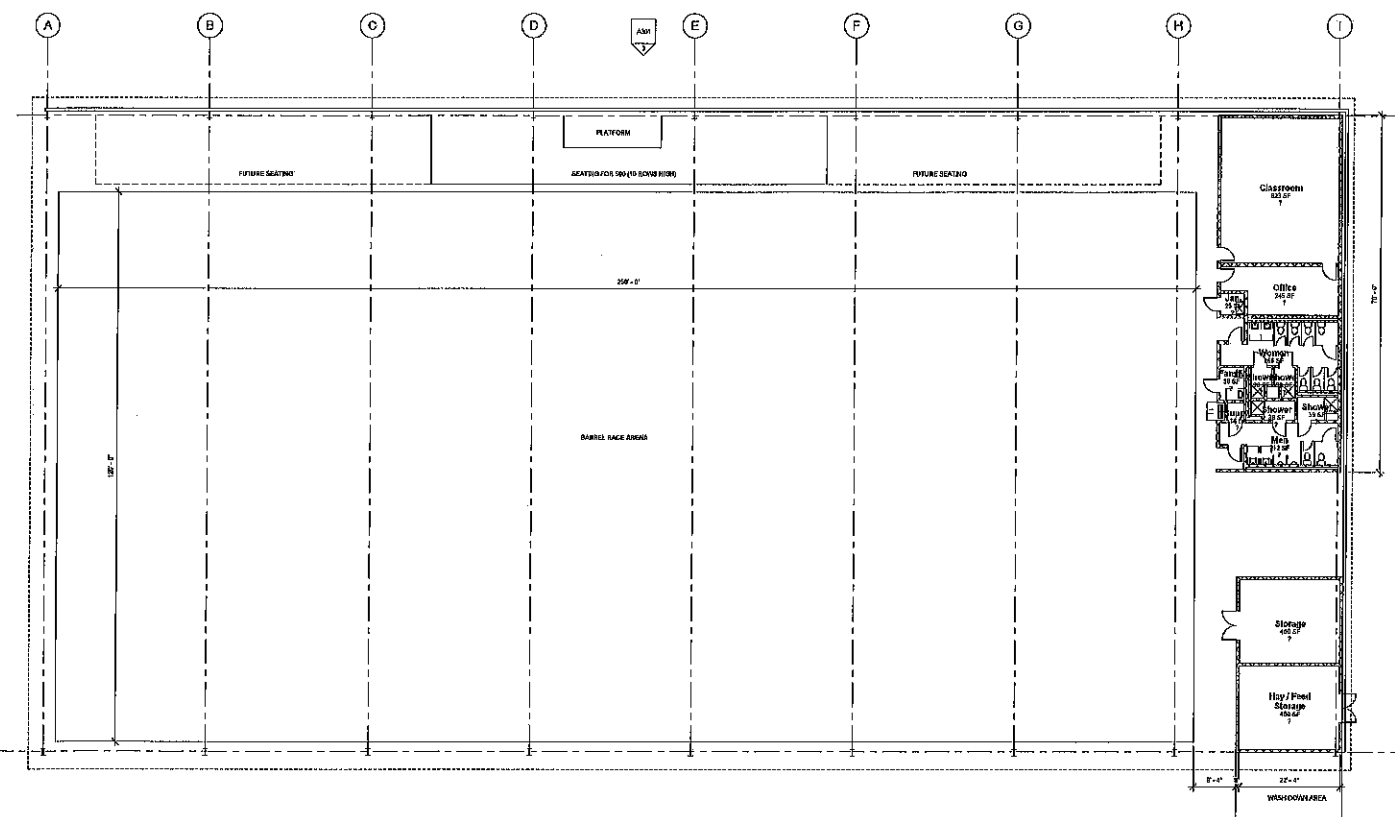

FIRST FLOOR PLAN
A101 3/12/19 1:40

CRAIG GAULDEN DAVIS

Architect
Planning
Interior
11 Washington Blvd.
Newark, NJ 07102
P: 973-261-1111
F: 973-261-1112
CAD: cga@cgadavis.com

COPYRIGHT © 2019, CRAIG GAULDEN & DAVIS, INC. ALL RIGHTS RESERVED.
THIS COPYRIGHTED DOCUMENT IS AN EXCLUSIVE PROPERTY OF CRAIG GAULDEN & DAVIS, INC. NO PART OF THIS DOCUMENT MAY BE REPRODUCED OR TRANSMITTED IN ANY FORM OR BY ANY MEANS, ELECTRONIC OR MECHANICAL, INCLUDING PHOTOCOPYING, RECORDING, OR BY ANY INFORMATION STORAGE AND RETRIEVAL SYSTEM, WITHOUT THE WRITTEN PERMISSION OF CRAIG GAULDEN & DAVIS, INC.



CONSULTANT

ANDERSON SCHOOL DISTRICT THREE

OWNER ADDRESS

FFA ARENA

PROJECT ADDRESS, STATE, ZIP CODE

EST. DATE DRAWN DATE

ISSUE:	SCHEMATIC
DATE:	6/20/19
PROJECT NO.:	19019
DRAWN BY:	SEP
CHECKED BY:	ESP

FFA ARENA FLOOR PLAN

A101

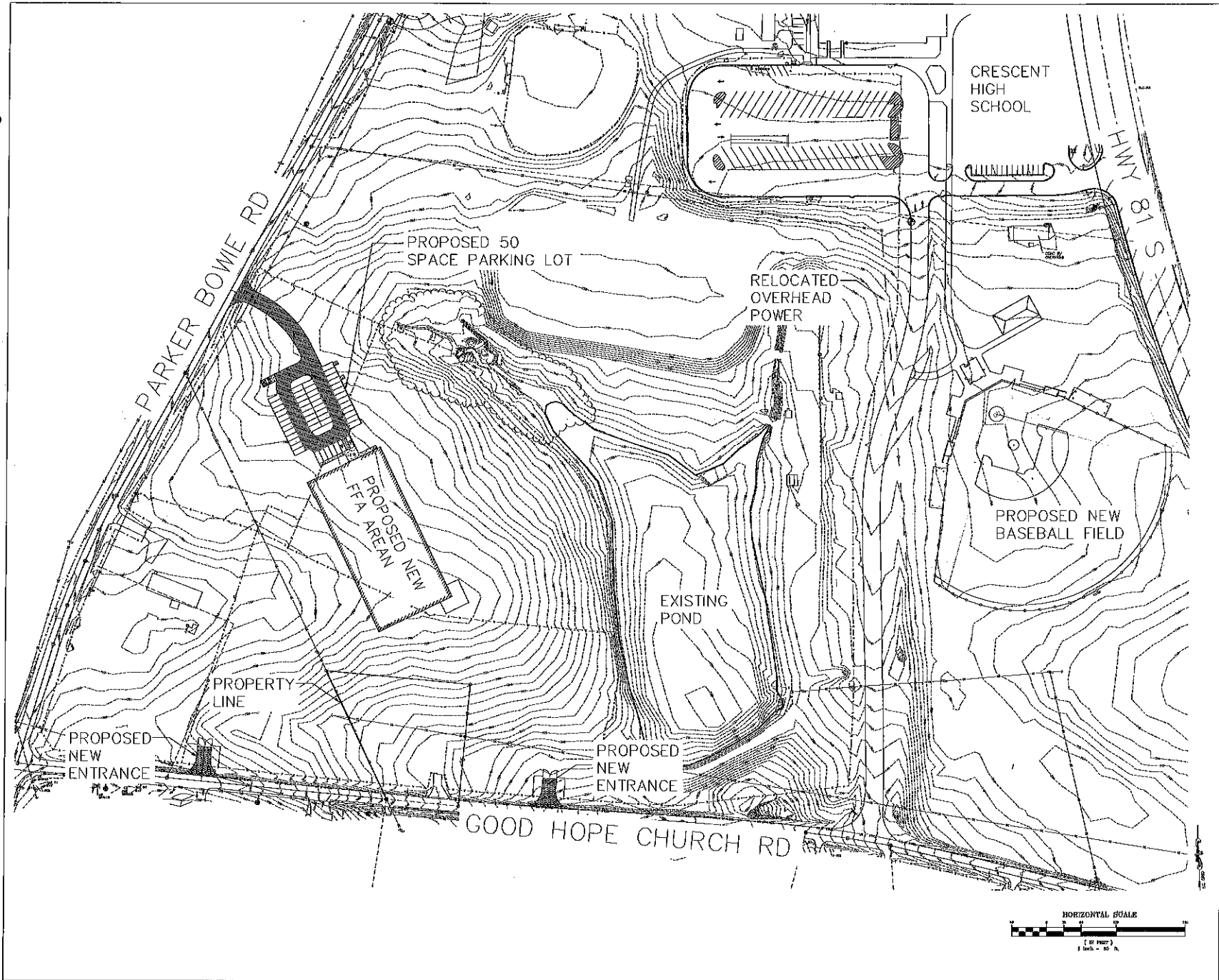

CRAIG GAULDEN DAVIS

Architectural
Planning
Interior
ID: 00000000000000000000
Phone: 888.542.3861
Fax: 800.888.8888
E-Mail: info@cgdavis.com

COPYRIGHT © 2010 CRAIG GAULDEN & DAVIS, INC. ALL RIGHTS RESERVED.
THIS DOCUMENT IS UNCLASSIFIED AND ALL INFORMATION CONTAINED HEREIN IS UNCLASSIFIED EXCEPT WHERE SHOWN OTHERWISE. IT IS THE PROPERTY OF CRAIG GAULDEN & DAVIS, INC. AND IS LOANED TO YOU BY THE ARCHITECT. THIS DOCUMENT IS THE EXCLUSIVE PROPERTY OF THE ARCHITECT AND NOT TO BE REPRODUCED OR TRANSMITTED IN ANY FORM OR BY ANY MEANS, ELECTRONIC OR MECHANICAL, INCLUDING PHOTOCOPYING, RECORDING, OR BY ANY INFORMATION STORAGE AND RETRIEVAL SYSTEM.



CONSULTANT
ADC
ENGINEERING SPECIALISTS
200 N. W. 10th St., Suite 1000
Ocala, FL 32101
352.345.1111
www.adc-engineers.com

ANDERSON SCHOOL DISTRICT THREE

PHASE 1 FFA ARENA & BASEBALL

PROJECT #2008.0101 STATE AP CODE

DATE	MARK	DESCRIPTION

ISSUE: DESIGN DEVELOPMENT
DATE: 01/26/2010
PROJECT NO: 10031
DRAWN BY: CPO
CHECKED BY: LKB

SITE PLAN
OVERALL
C250



1 2 3 4 5

D
C
B
A